

Gearbox **WVSA/WVSFA Series**

Down Angle Design

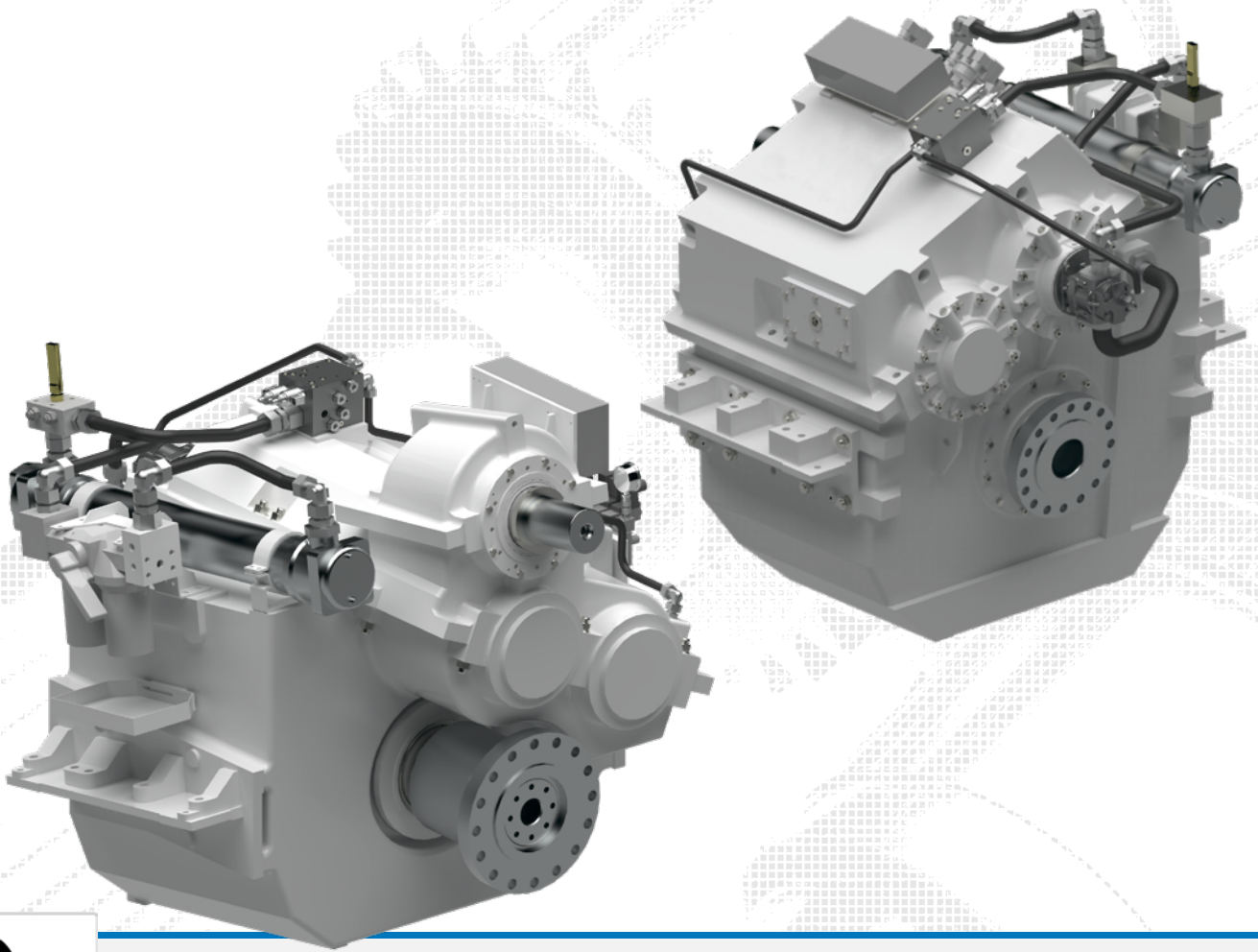

**QUALITY
MADE IN
GERMANY**

WVSA/WVSFA Series

- WVSA

Reverse reduction gearbox shafts offset for fast vessels in down angle design with beveloid gear step (Wendeuntersetzungsgetriebe AchsVersetzt für Schnelle Schiffe in Down-Angle-Ausführung mit Beveloid-Radstufe)

- WVSFA U

Reverse reduction gearbox shafts offset for fast vessels in down angle design with flange-connected housing beveloid gear step as U-drive (Wendeuntersetzungsgetriebe AchsVersetzt für Schnelle Schiffe in Down-Angle-Ausführung mit angeflanschter Beveloid-Vorsatzstufe als U-Trieb)

- ZWVSFA U

Reverse reduction gearbox shafts offset for fast vessels in down angle design with flange-connected housing beveloid gear step as U-drive (Zweigang-Wendeuntersetzungsgetriebe AchsVersetzt für Schnelle Schiffe in Down-Angle-Ausführung mit angeflanschter Beveloid-Vorsatzstufe als U-Trieb)

Customer Benefits

- Down angle in order to save space
- Optimal low noise gear design
- Wide range of available reduction ratios in fine increments
- Light and robust design for demanding operating profiles and applications
- Split design housing for ease of on-site maintenance
- Hybrid options available
- Compact design in vertical direction enabling optimal positioning in the engine room
- Dedicated gearing design with optimised offsets to satisfy requirements for compact propulsion train arrangement

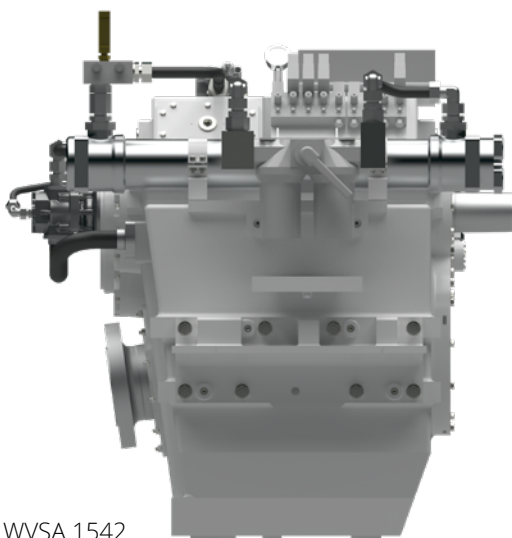

WVSA 1542

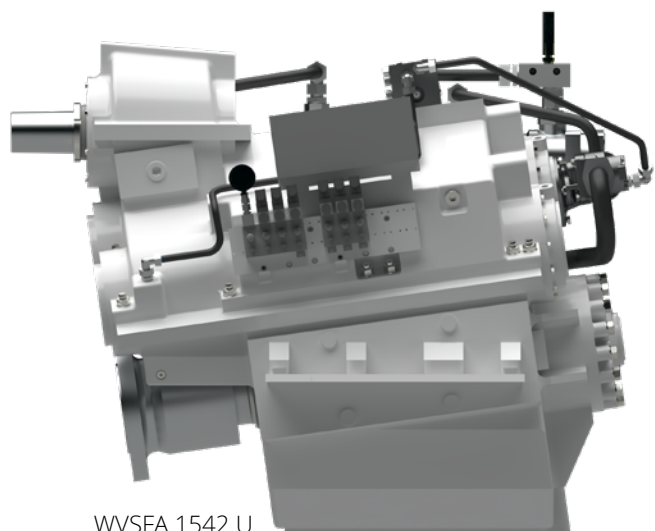

WVSFA 1542 U

Standard

Scope of supply

- Aluminium housing
- Beveloid toothed spur gears, case hardened
- Built-in hydraulically operated REINTJES disc clutches with steel/sintered friction surface
- Built-in propeller thrust bearing
- Electric control valve/GBX-C:
 - Smooth engagement by optimised pressure build-up
- Full power transmission in both directions of rotation
- Integrated oil sump with common circuit for operating pressure and cooling
Oil pump and oil filter accessible from outside
- Integrated, seawater resistant oil cooler for cooling water inlet temperature up to 32 °C
- Input free end with 1:30 taper
- Forged-on output flange
- Paint finish with synthetic resin varnish in RAL 7001 colour silver grey
- Reduction ratios: up to 16 different ratios available
- Free standing (no SAE housing)
- Rigid foundation with bolted mounting feet
- Supervision acc. to REINTJES standard with double filter

Available options

- Auxiliary drives:
 - PTO, non-controllable K21A, K31B
 - PTI/PTO (Hybrid drives), non-controllable K21B, K31B
 - PTI/PTO (Hybrid drives), controllable execution (K35B) with optional holding device for e-motor
- Flexible coupling
- Electric stand-by pump (supplied separately)
- Output counter flange
- Oil cooler 38 °C water inlet temperature
- Electric control valve GBX-A
 - Comfort clutch with easy adjustable engagement times according to customer requirement
 - Trolling function (ADS)
- Resilient mounting
- Screw-on mounting
- Two-speed option for WVSFA (ZWVSA xxx U) available for sizes 442, 742 & 942

Class acceptance

- Type approval (LRS, RINA, BV, CR)
- Drawing approval
- Full class according to classification society incl. supervision

Space saving design

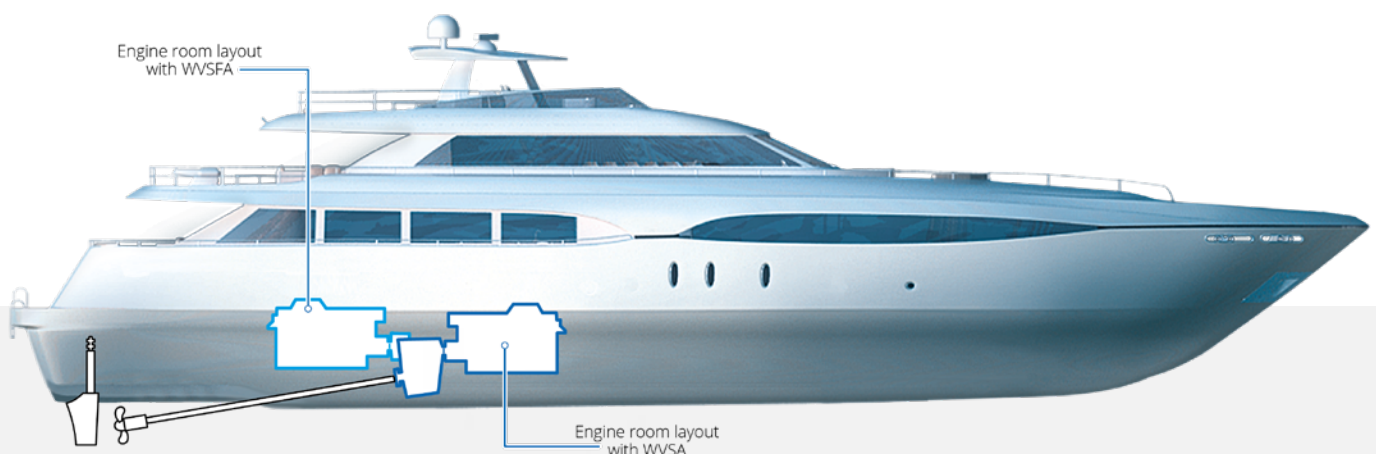

WVSA Series

| Size | WVSA 1542 | WVSA 1942 |
|-------------------|------------|------------|
| Input Speed (rpm) | 1600-2300 | 1600-2300 |
| Input Torque (kW) | 1400-3500 | 1800-4900 |
| P/n max (kW/rpm) | up to 1.55 | up to 2.04 |

Dimensions (mm)

| | | |
|------------------|-------|-------|
| L1 | 142 | 154 |
| L2 | 909.4 | 997 |
| H1 | 860 | 960 |
| H2 | 457.9 | 500 |
| H3 | 600 | 640 |
| H4 | 370 | 415 |
| B1 | 650 | 650 |
| B2 | 1380 | 1420 |
| D1 | 106.9 | 116.9 |
| D2 | 330 | 330 |
| α (alpha) | 8 ° | 8° |
| Dry Weight (kg) | 1700 | 2050 |
| Oil (l) | 140 | 170 |

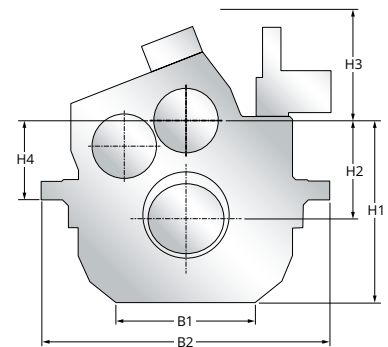
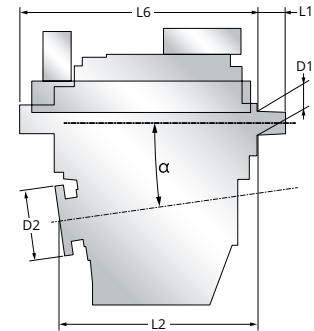
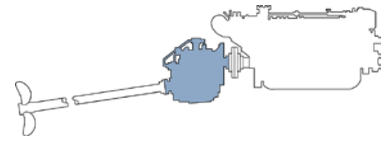

Power Ratings

| | kW min. | kW max. | BHP min. | BHP max. |
|--------------|---------|---------|----------|----------|
| WVSA 1542 | 1.496 | 3.565 | 2.006 | 4.781 |
| WVSA 1942 | 1.882 | 4.692 | 2.524 | 6.292 |
| WVSFA 442 U | 733 | 1.462 | 983 | 1.961 |
| WVSFA 742 U | 1.112 | 2.300 | 1.491 | 3.084 |
| WVSFA 942 U | 1.460 | 3.052 | 1.958 | 4.093 |
| WVSFA 1542 U | 2.118 | 3.410 | 2.840 | 4.573 |
| WVSFA 1942 U | 2.331 | 3.844 | 3.126 | 5.155 |

Noise reduced REINTJES beveloid toothing

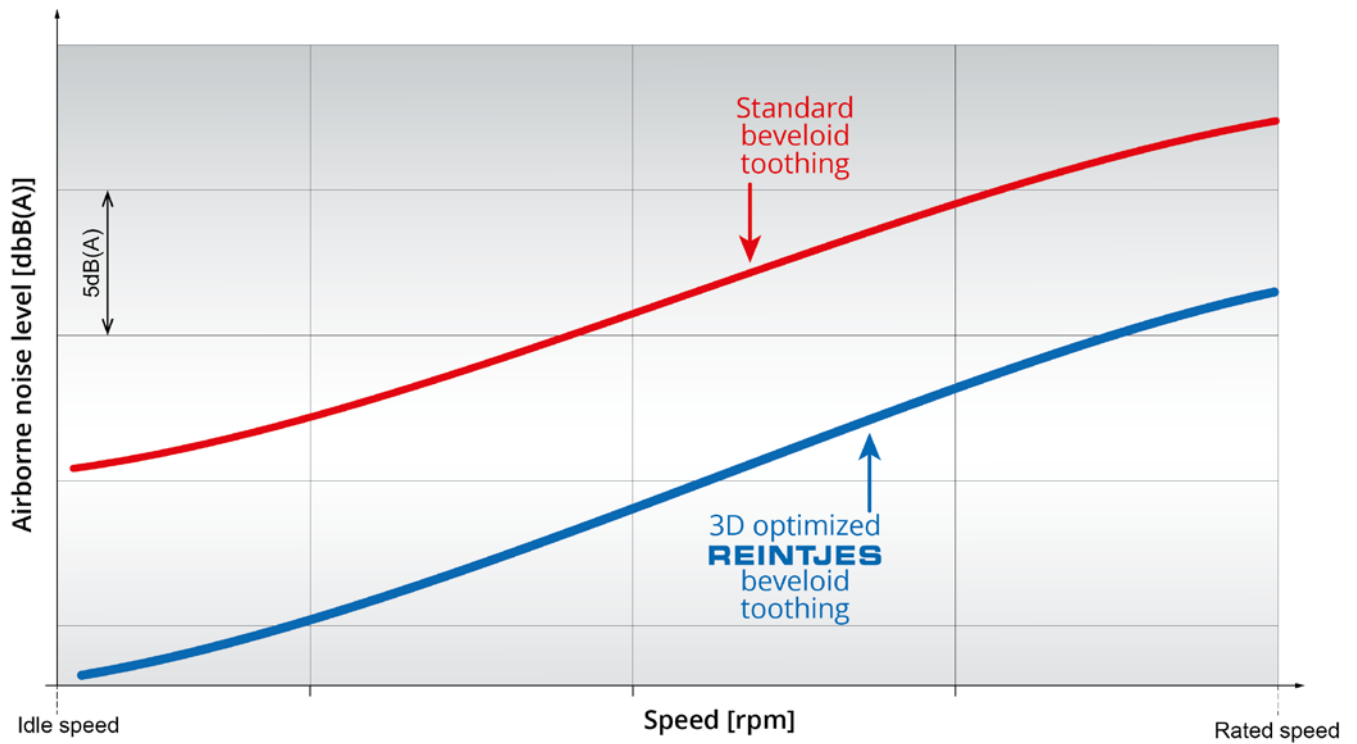

© REINTJES GmbH

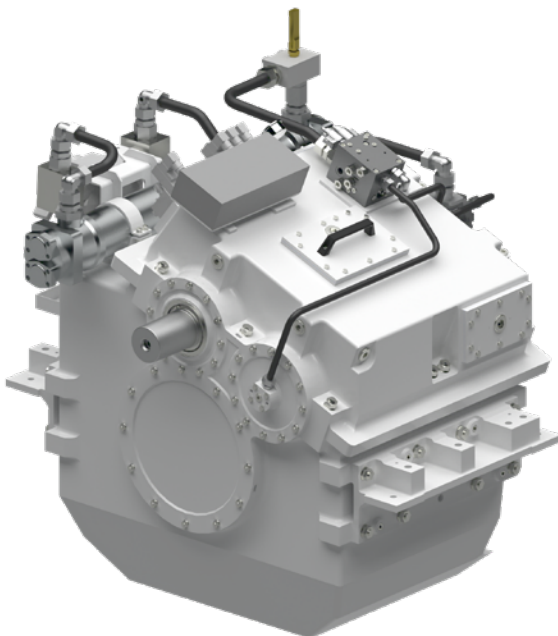

WWSA 1542, engine side

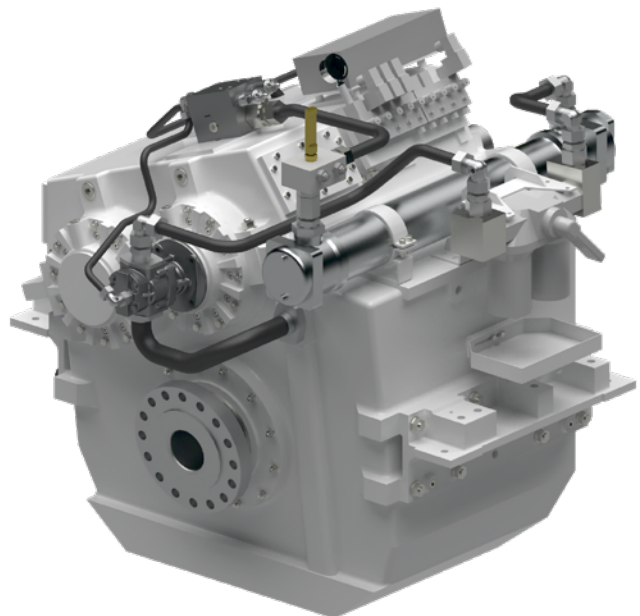

WWSA 1542, propeller side

WVSFA Series

| Size | WVSFA 442 U | WVSFA 742 U | WVSFA 942 U | WVSFA 1542 U | WVSFA 1942 U |
|-------------------|-------------|-------------|-------------|--------------|--------------|
| Input Speed (rpm) | 1600-2500 | 1600-2350 | 1600-2350 | 1600-220 | 1600-2150 |
| Input Torque (kW) | 700-1400 | 1100-2300 | 1400-3000 | 2100-3400 | 2300-3800 |
| P/n max (kW/rpm) | up to 0.645 | up to 0.932 | up to 1.299 | up to 1.665 | up to 2.048 |

Dimensions (mm)

| | | | | | |
|----|-------|-------|-------|-------|-------|
| L1 | 97 | 107 | 117 | 142 | 154 |
| L2 | 64.7 | 103 | 132 | 142.3 | 141.7 |
| L6 | 1190 | 1330 | 1420 | 1530 | 1630 |
| H1 | 880 | 810 | 890 | 1010 | 1100 |
| H2 | 556.6 | 566.7 | 628.8 | 697.4 | 726 |
| H3 | 470 | 390 | 425 | 490 | 400 |
| H4 | 425.2 | 510 | 585 | 630 | 700 |
| B1 | 540 | 560 | 560 | 600 | 650 |
| B2 | 1090 | 1130 | 1170 | 1360 | 1360 |
| D1 | 74.9 | 91.9 | 101.9 | 106.9 | 116.9 |
| D2 | 280 | 300 | 300 | 375 | 375 |

α (alpha)

| | | | | | |
|-----------------|-----|------|------|------|------|
| Dry Weight (kg) | 900 | 1100 | 1350 | 2100 | 2400 |
| Oil (l) | 60 | 88 | 98 | 135 | 190 |

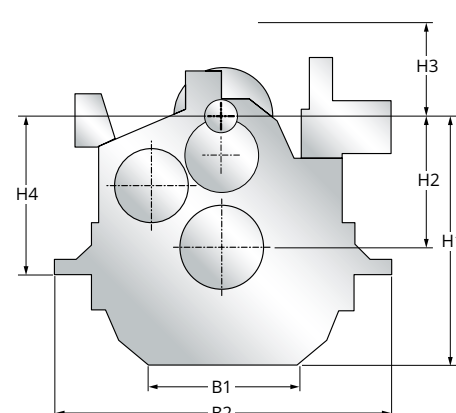
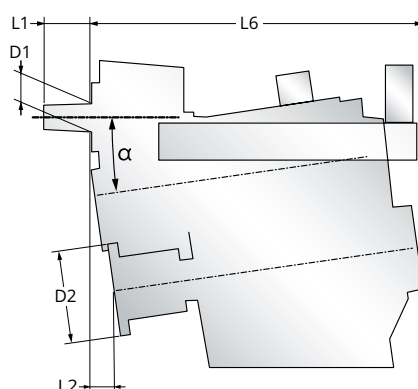
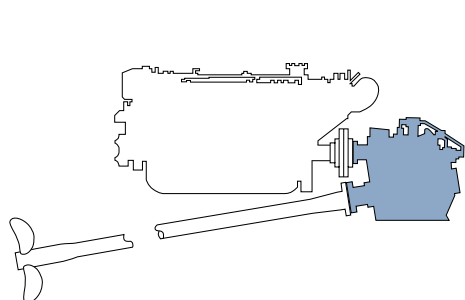

Connection to engine without cardan shaft

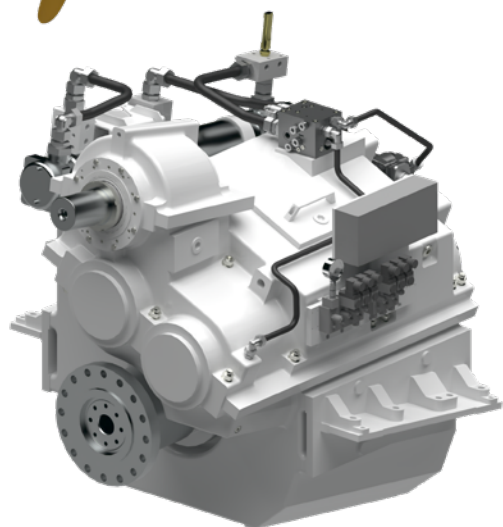
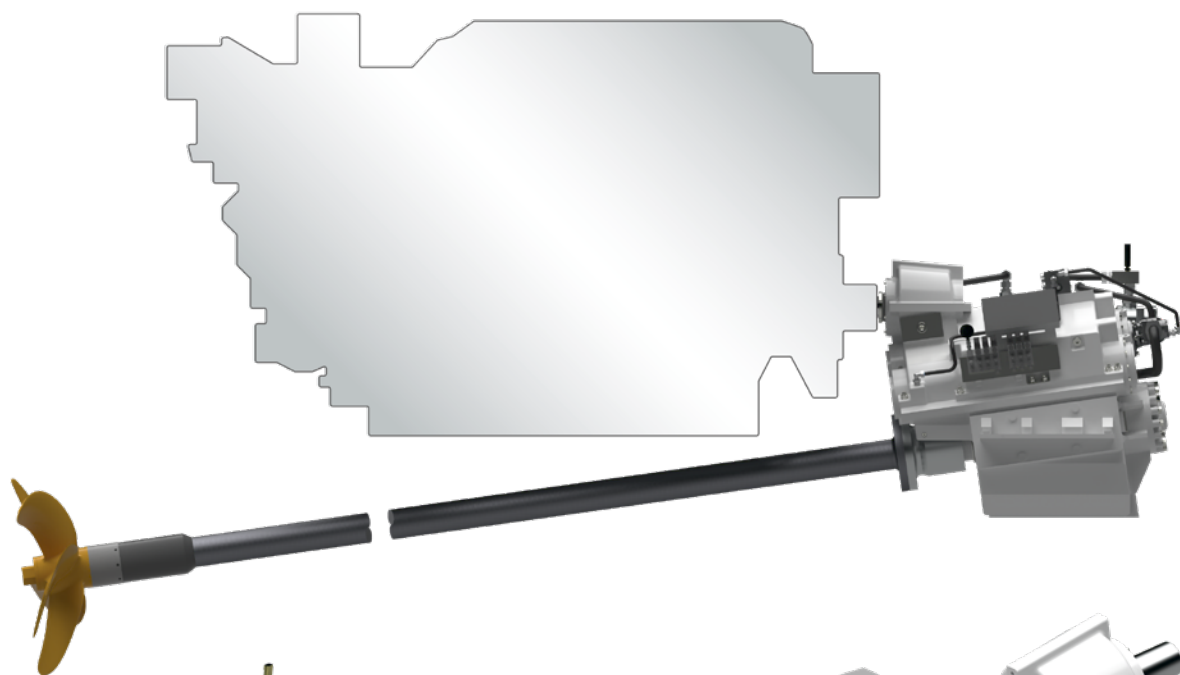

WWSFA 1542 U, engine and propeller side

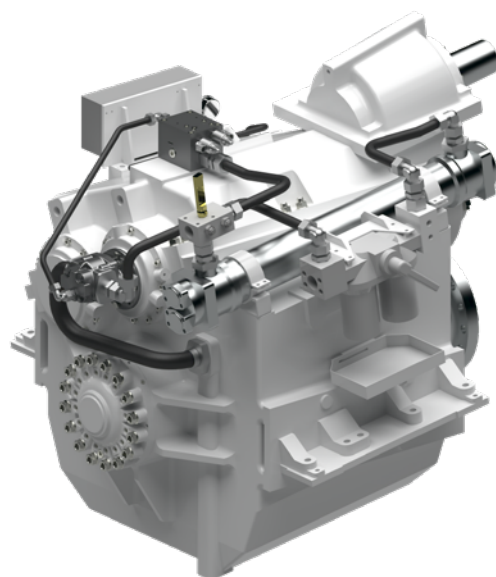

WWSFA 1542 U, free end



This document and any data contained herein are subject to modifications or updates at any time and are always non-binding. The data serve informational purposes and cannot be guaranteed in any way. In addition, any data and information will be assessed and determined individually for each project and purpose. This is necessary due to differing characteristics of each project. If this document is delivered in another language than English and in case of divergences of interpretation between the different language texts, the English text shall prevail. Pictures and logos courtesy from all owners of the respective trademarks and rights. Gearbox standard design is dry. All lists only show an extract of gearboxes available. Additional sizes, offset configurations and variations are available on request.

Dimensions and dry weights are approximate and may vary with housing or by input and ratio. Specifications are subject to change without notice. Please contact your REINTJES distributor for current information and binding data.

REINTJES GmbH
Eugen-Reintjes-Straße 7
31785 Hameln
Germany

E-Mail: info@reintjes-gears.de
Phone: +49 5151 1040

www.reintjes-gears.com

Scan here to
download all our
product brochures

